



型号及功率MODEL & POWER



SKG 274 Brushless Synchronous AC Alternators

型号Model	额定功率Power(1500rpm/50Hz)400V		额定功率Power(1800rpm/60Hz)440V	
	KW	KVA	KW	KVA
SKG164A	6.5	8.1	8.2	10.2
SKG164B	8.8	11.0	11	13.8
SKG164C	10.8	13.5	13.5	16.9
SKG164D	12.8	16	16.0	20.0
SKG184E	18	22.5	23.0	28.8
SKG184F	22	27.5	27.5	34.4
SKG184G	25	31.3	30	37.5
SKG184H	30	37.5	37.5	46.9
SKG184J	32	40	40	50
SKG224C	34	42.5	42	52.5
SKG224D	40	50	50	62.5
SKG224E	48	60	56	70
SKG224F	58	72.5	70	87.5
SKG224G	68	85	78	97.5
SKG274C	80	100	94	118
SKG274D	96	120	110	138
SKG274E	112	140	134	168
SKG274F	128	160	152	190
SKG274G	144	180	170	213
SKG274H	160	200	196	245
SKG314C	200	250	235	294
SKG314D	236	295	280	350
SKG314E	260	325	315	394
SKG314F	304	380	365	456

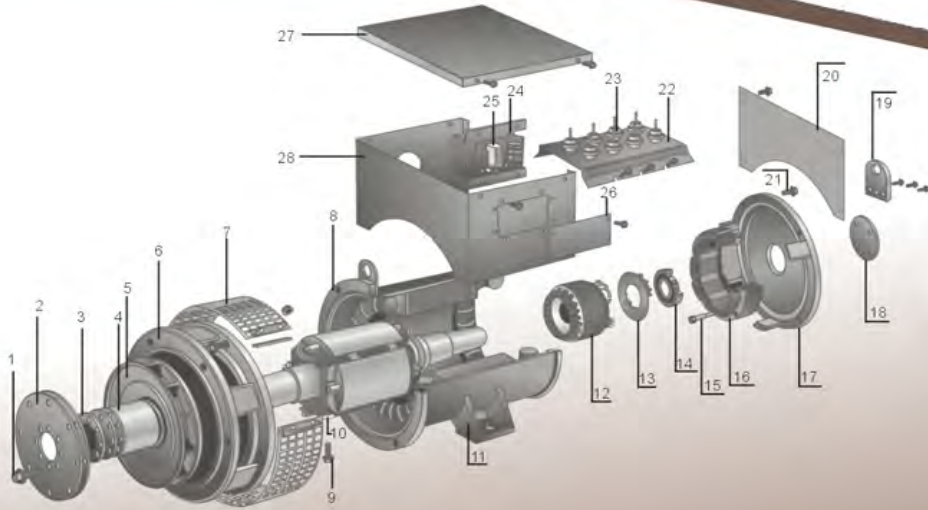

- 01. BOLT
- 02. FLEX PLATE
- 03. DRIVE PLATE
- 04. FLEXOR
- 05. FAN
- 06. FRONT COVER
- 07. COVERING PLATE
- 08. STATOR WITH WINDING
- 09. BOLT
- 10. ROTOR WITH SHAFT
- 11. EARTHING TERMINAL
- 12. EXCITATING ROTOR
- 13. ROTARY RECTIFIER
- 14. BEARING
- 15. EXCITATING STATOR BOLT
- 16. EXCITATING STATOR
- 17. BACK SHIELD
- 18. BEARING COVER
- 19. EYEBOLT
- 20. TERMINAL BOX-END PLATE
- 21. BOLT
- 22. TERMINAL BOARD
- 23. TERMINAL POLE
- 24. AVR FRAME
- 25. AVR
- 26. TERMINAL BOX-SIDE PLATE
- 27. TERMINAL BOX-TOP COVER
- 28. TERMINAL BOX-FRONT PLATE

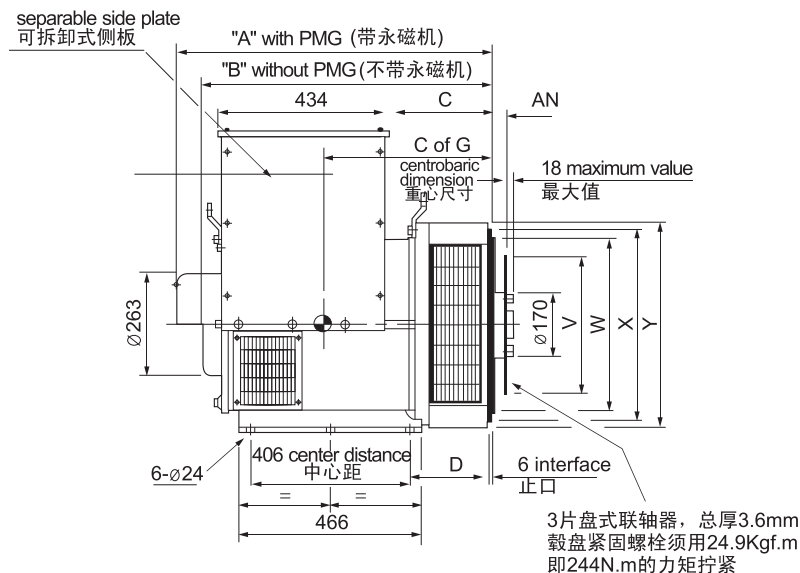
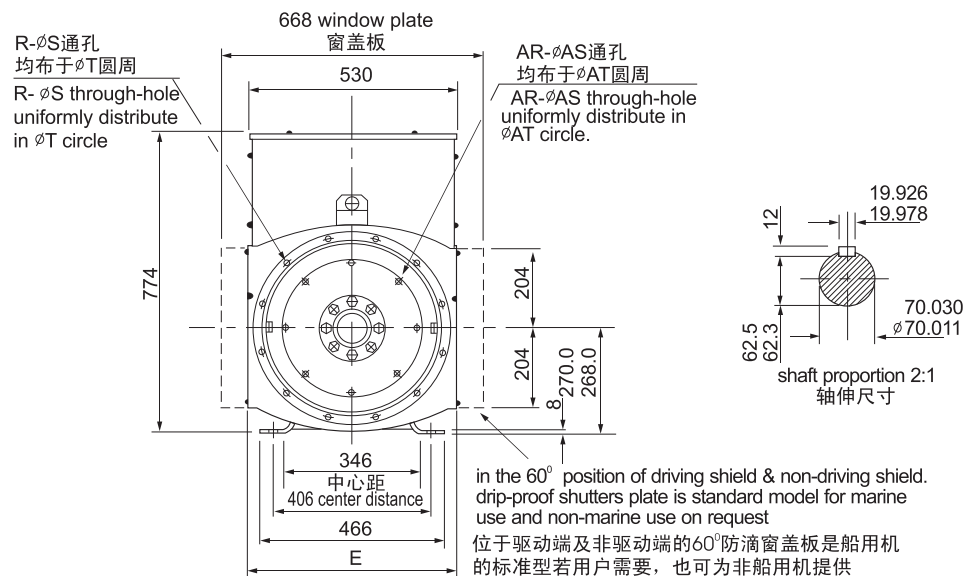

DIMENSION 尺寸 (mm)						
	型号 Model	A	B	C	E	Cof G
SAE1	SKG 274C	813.3	750.3	274.3	554	365
	SKG 274D	813.3	750.3	274.3	554	375
	SKG 274E	928.3	865.3	389.3	554	390
	SKG 274F	928.3	865.3	389.3	554	415
	SKG 274G	978.3	915.3	439.3	554	435
	SKG 274H	1018.3	955.3	479.3	554	455
SAE2&3	SKG 274C	799	736	260	554	398
	SKG 274D	799	736	260	554	422
	SKG 274E	914	851	375	554	489
	SKG 274F	914	851	375	554	527
	SKG 274G	964	904	425	554	579
	SKG 274H	1004	941	465	554	625

FLANGE 法兰式过渡接套 (mm)							
S.A.E.NO.	D	R	S	T	W	X	Y
1	216.3	12	12.7	530.2	511.1	553	580
2	202	12	11	466.7	447.6	490	530
3	202	12	11	428.6	409.5	451	530

DISC COUPLING 盘片式联轴器 (mm)					
S.A.E.NO.	AN	AR	AS	AT	V
10	59.98	8	10.3	295.3	314.2
11.5	39.68	8	10.3	333.3	352.3
14	25.40	8	13.5	438.2	466.6

TRANSPORTATION DATA 运输数据			
型号 Model	N.W(kg)	G.W(kg)	LXWXH(cm)
SKG 274C	385	415	125X76X102
SKG 274D	405	435	125X76X102
SKG 274E	455	485	125X76X102
SKG 274F	500	530	125X76X102
SKG 274G	550	580	125X76X102
SKG 274H	600	630	125X76X102

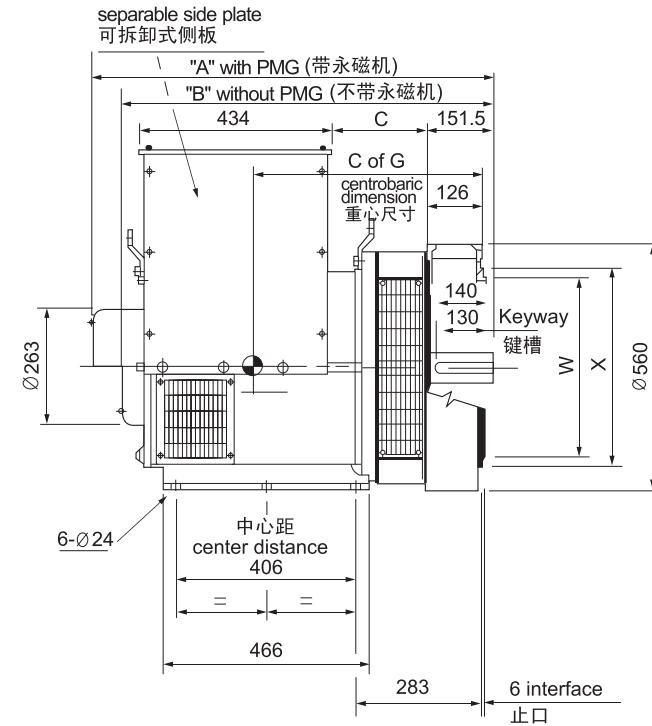
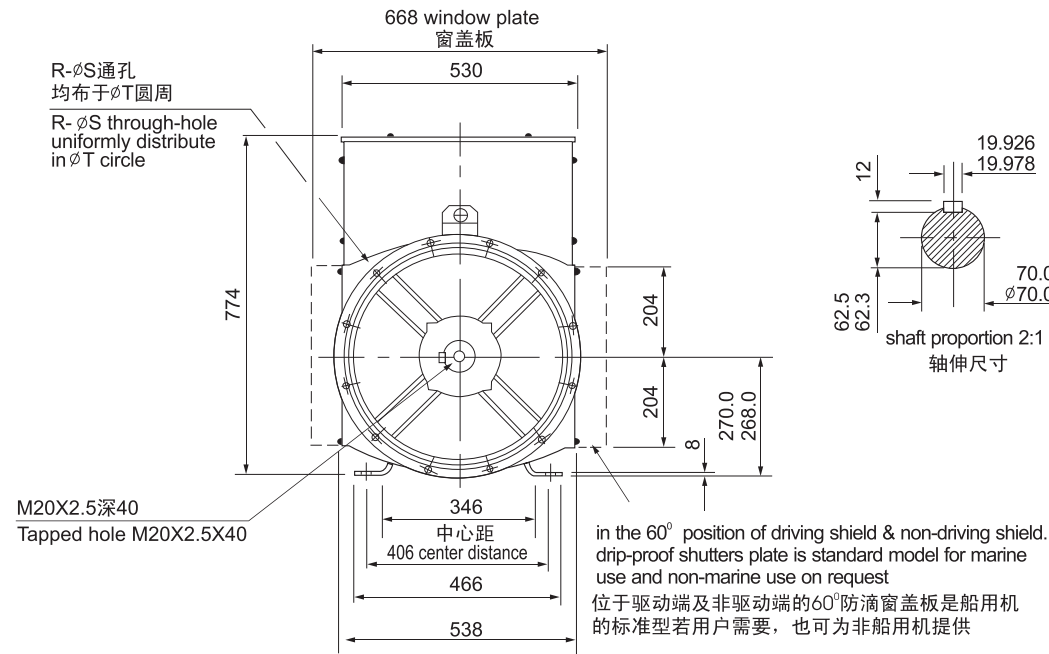

DIMENSION 尺寸 (mm)

型号 Model	A	B	C	Cof G
SKG 274C	905	842	215	420
SKG 274D	905	842	215	430
SKG 274E	1020	957	330	445
SKG 274F	1020	957	330	475
SKG 274G	1070	1007	380	490
SKG 274H	1110	1047	420	510

TRANSPORTATION DATA 运输数据

型号 Model	N.W(kg)	G.W(kg)	LXWXH(cm)
SKG 274C	395	435	125X76X102
SKG 274D	420	460	125X76X102
SKG 274E	470	510	125X76X102
SKG 274F	510	550	125X76X102
SKG 274G	560	600	125X76X102
SKG 274H	610	650	125X76X102

FLANGE 法兰式过渡接套 (mm)

S.A.E.NO.	R	S	T	W	X
1	12	12.7	530.2	511.1	553
2	12	11	466.7	447.6	495
3	12	11	428.6	409.5	451