



型号及功率MODEL & POWER



SKG 164 Brushless Synchronous AC Alternators

型号Model	额定功率Power(1500rpm/50Hz)400V		额定功率Power(1800rpm/60Hz)440V	
	KW	KVA	KW	KVA
SKG164A	6.5	8.1	8.2	10.2
SKG164B	8.8	11.0	11	13.8
SKG164C	10.8	13.5	13.5	16.9
SKG164D	12.8	16	16.0	20.0
SKG184E	18	22.5	23.0	28.8
SKG184F	22	27.5	27.5	34.4
SKG184G	25	31.3	30	37.5
SKG184H	30	37.5	37.5	46.9
SKG184J	32	40	40	50
SKG224C	34	42.5	42	52.5
SKG224D	40	50	50	62.5
SKG224E	48	60	56	70
SKG224F	58	72.5	70	87.5
SKG224G	68	85	78	97.5
SKG274C	80	100	94	118
SKG274D	96	120	110	138
SKG274E	112	140	134	168
SKG274F	128	160	152	190
SKG274G	144	180	170	213
SKG274H	160	200	196	245
SKG314C	200	250	235	294
SKG314D	236	295	280	350
SKG314E	260	325	315	394
SKG314F	304	380	365	456

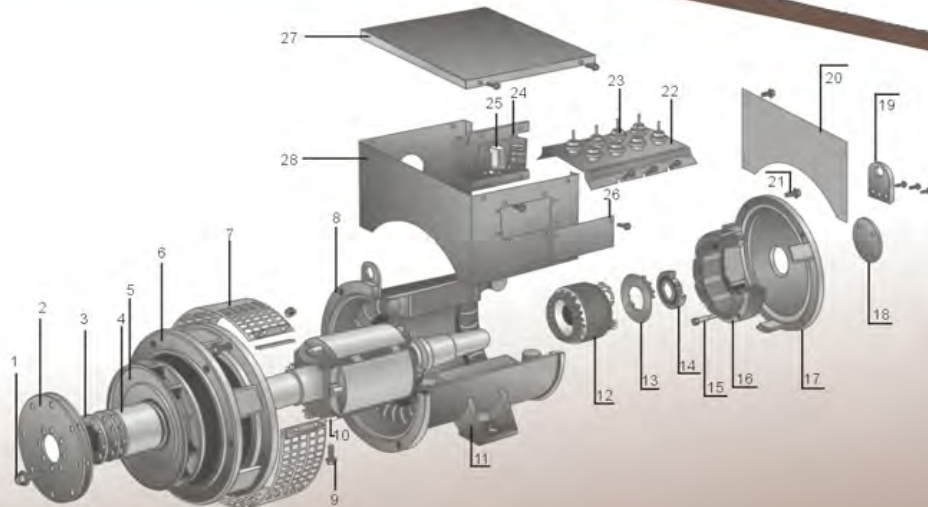

- 01. BOLT
- 02. FLEX PLATE
- 03. DRIVE PLATE
- 04. FLEXOR
- 05. FAN
- 06. FRONT COVER
- 07. COVERING PLATE
- 08. STATOR WITH WINDING
- 09. BOLT
- 10. ROTOR WITH SHAFT

- 11. EARTHING TERMINAL
- 12. EXCITATING ROTOR
- 13. ROTARY RECTIFIER
- 14. BEARING
- 15. EXCITATING STATOR BOLT
- 16. EXCITATING STATOR
- 17. BACK SHIELD
- 18. BEARING COVER
- 19. EYEBOLT
- 20. TERMINAL BOX-END PLATE

- 21. BOLT
- 22. TERMINAL BOARD
- 23. TERMINAL POLE
- 24. AVR FRAME
- 25. AVR
- 26. TERMINAL BOX-SIDE PLATE
- 27. TERMINAL BOX-TOP COVER
- 28. TERMINAL BOX-FRONT PLATE

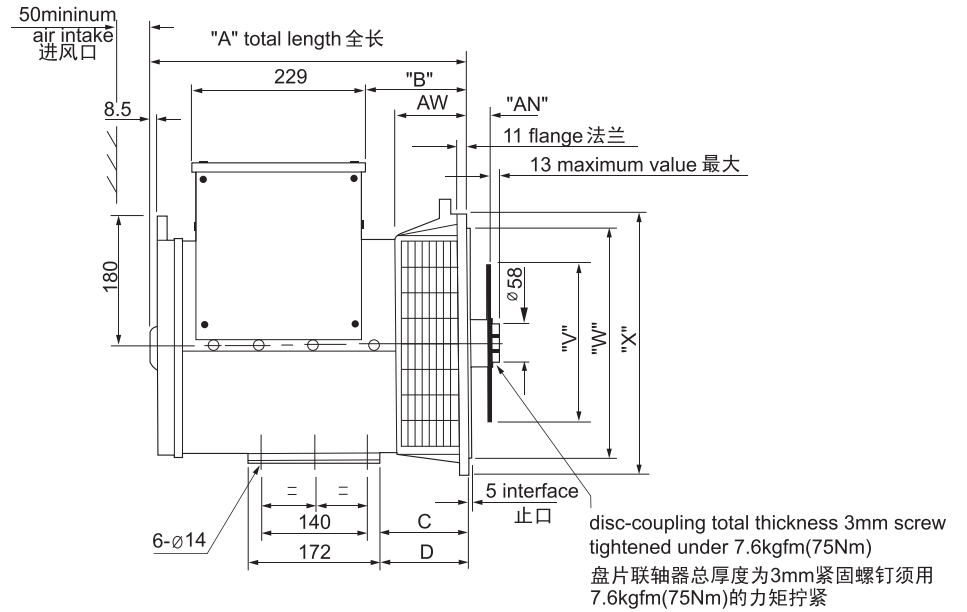
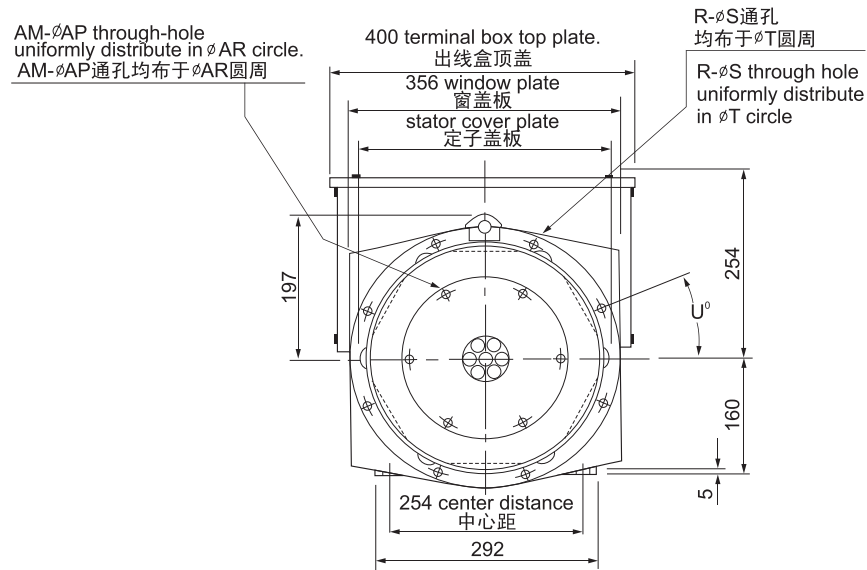

DIMENSION 尺寸 (mm)		
型号 Model	A*	B
SKG 164A	364.5	93
SKG 164B	364.5	93
SKG 164C	391.5	107
SKG 164D	391.5	107

FLANGE 法兰式过渡接套 (mm)									
S.A.E.NO.	AW	R	S	T	U°	W	X	C	D
2	132.3	12	11	466.7	15	447.6	489	172	156
3	105	8	11	428.6	15	409.5	451	145	129
4	93	8	11	381.0	15	361.9	402	133	117
5	93	8	11	333.3	22.5	314.3	356	133	117
6*	124.7	8	11	285.8	22.5	266.7	308	164.7	148.7

DISC COUPLING 盘片式联轴器 (mm)					
S.A.E.NO.	AN	AM	AP	AR	V
6.5	30.16	6	8.7	200.0	215.8
7.5	30.16	8	8.7	222.2	241.2
8	61.9	6	11	244.5	263.4
10	53.98	8	11	295.3	314.2

TRANSPORTATION DATA 运输数据			
型号 Model	N.W(kg)	G.W(kg)	LXWXH(cm)
SKG 164A	85	95	64x54x72
SKG 164B	90	102	64x54x72
SKG 164C	96	110	64x54x72
SKG 164D	99	116	64x54x72

注:\*SAE6需另加一厚31.7mm的过渡板,故"A"尺寸也相应增加31.7mm

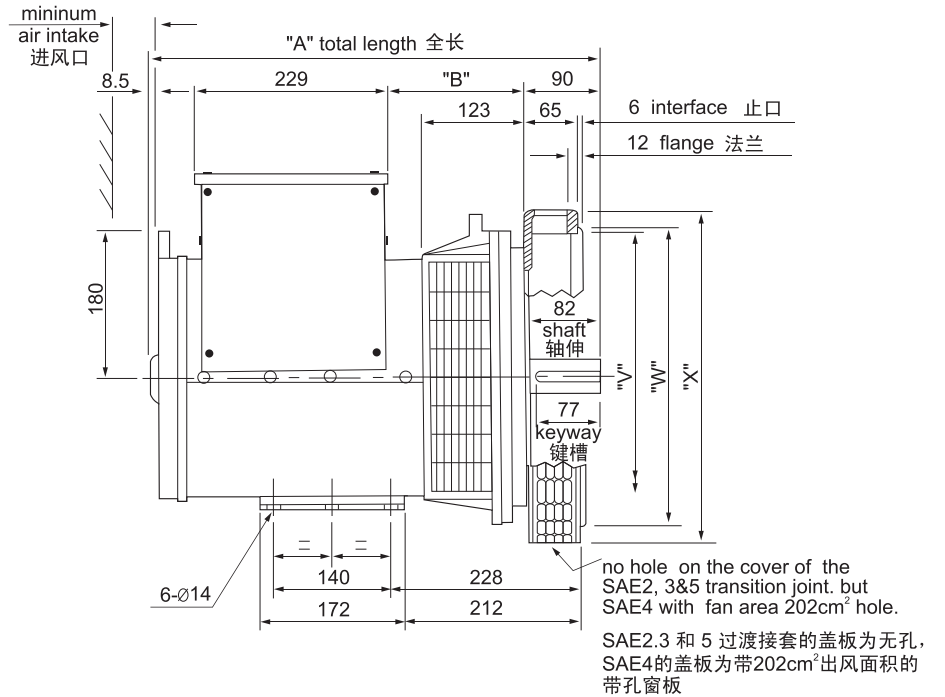
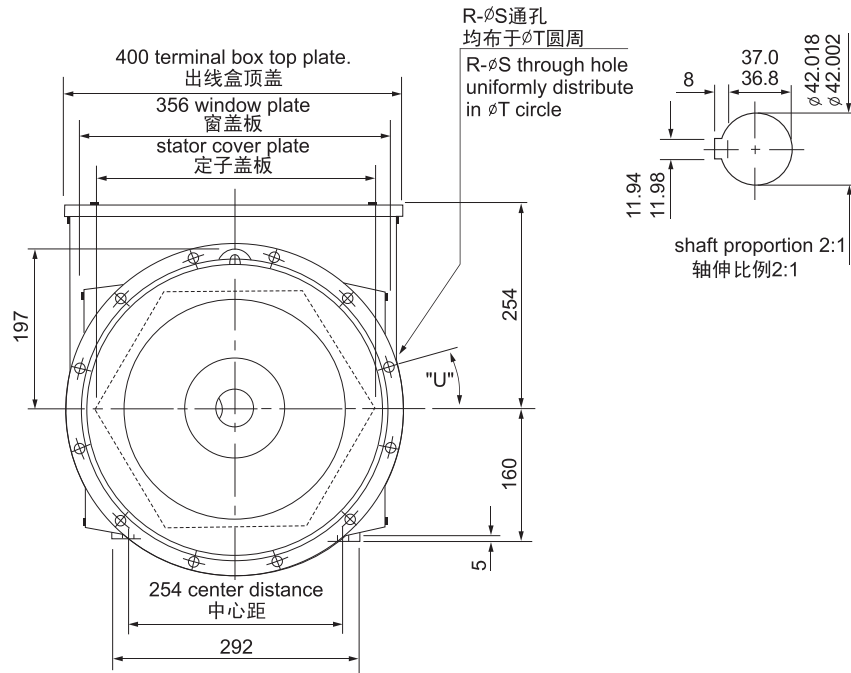

DIMENSION 尺寸 (mm)		
型号 Model	A	B
SKG 164A	484.5	123
SKG 164B	484.5	123
SKG 164C	511.5	137
SKG 164D	511.5	137

TRANSPORTATION DATA 运输数据			
型号 Model	N.W(kg)	G.W(kg)	LXWXH(cm)
SKG 164A	91	101	64x54x72
SKG 164B	98	108	64x54x72
SKG 164C	106	116	64x54x72
SKG 164D	112	122	64x54x72

FLANGE 法兰式过渡接套 (mm)							
S.A.E.NO.	R	S	T	UO	V	W	X
2	12	11	466.7	15	432	447.6	495
3	12	11	428.6	15	396	409.5	451
4	12	11	381.0	15	352	361.9	403
5	8	11	333.3	22.5	301	314.3	356